

**NOTE:**

THIS PLAN IS FOR INFORMATION PURPOSES ONLY TO BE USED BY BREVARD COUNTY AS A CONCEPTUAL PLAN FOR LOT DESIGN.

**JANUARY 2025**

# SPACEPORT COMMERCE PARK

SECTION 3&4, TOWNSHP 23 SOUTH, RANGE 35 EAST, BREVARD COUNTY, FLORIDA

GRAPHIC SCALE

( IN FEET )  
1 inch = 200 ft.

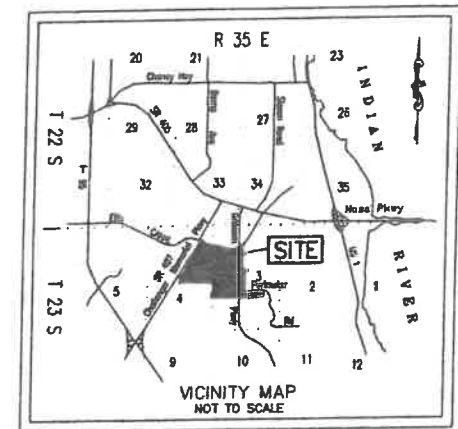

NOTES: (AS SHOWN ON THE RECORD PLAT "ENTERPRISE PARK", PLAT BOOK 32, PAGE 74)

1. PARCEL "G" IS RESERVED FOR PUBLIC USE AND IS TO BE PRESERVED IN ITS NATURAL STATE.
2. BEARINGS ARE BASED ON D.O.T. RIGHT OF WAY MAP FOR 407.
3. A 15' EASEMENT FOR DRAINAGE AND UTILITIES IS TO BE RESERVED ALONG ALL FUTURE SIDE AND REAR PROPERTY LINES.
4. THERE IS A HEIGHT RESTRICTION WITHIN THE AIRPORT CLEAR ZONE FOR INFORMATION SEE O.R.B. 947, PG. 688.
5. THERE IS A 25' DRAINAGE & UTILITY EASEMENT RESERVED ALONG ALL PLAT BOUNDARY LINES EXCEPT THAT LINE LYING IN THE CENTERLINE OF ELLIS CANAL.
6. RESTRICTIVE COVENANTS RECORDED IN O.R.B. 2460, PAGE 2995 & AMENDED IN O.R.B. 2508, PAGE 2917 PUBLIC RECORDS OF BREVARD COUNTY, FLORIDA.

**ABBREVIATION**

CALC = CALCULATED  
CL = CENTERLINE  
FM = FIELD MEASURED  
ORB = OFFICIAL RECORD BOOK  
PB = PLAT BOOK  
PC = POINT OF CURVATURE  
PG = PAGE  
POC = POINT ON A CURVE  
PRC = POINT OF REVERSE CURVATURE  
R/W = RIGHT OF WAY  
R = RADIUS  
D = DELTA ANGLE  
L = ARC LENGTH

## POTENTIAL LOTS APPROXIMATE ACREAGE

LOT 1:	6.0	LOT 6:	4.0
LOT 2:	7.0	LOT 7:	4.0
LOT 3:	30.0	LOT 8:	13.0
LOT 4:	2.0	LOT 9:	8.2
LOT 5:	12.0		

TYPE OF SURVEY:  
SPACEPORT COMMERCE PARK  
CONCEPTUAL PLAN

REVISION: OWNERSHIP UPDATE 10-28-19  
REVISION: PARTIAL UPDATE 01-03-13 (PER TONY VITALE)  
REVISION: ADD AERIAL 02-20-08 (PER GREG LUGAR)  
REVISION: UPDATE OWNER 11-22-06 (PER GREG LUGAR)  
REVISION: UPDATE AND DIVIDE LOTS 07-06-06 (PER GREG LUGAR)  
REVISION: UPDATE AND DIVIDE LOTS 11-04-05 (PER GREG LUGAR)  
REVISION: UPDATE OWNER 10-06-05 (PER GREG LUGAR)  
REVISION: UPDATE LOTS 04-13-05 (PER GREG LUGAR)  
REVISION: UPDATE LOTS 12-01-04 (PER GREG LUGAR)  
REVISION: UPDATE AND DIVIDE LOTS 1-20-04 (PER GREG LUGAR)  
REVISION: ADD EASEMENTS 1-12-00  
REVISION: ADD EASEMENTS 12-1-99

PREPARED FOR:  
BREVARD COUNTY  
ECONOMIC & FINANCIAL PROGRAMS

OCTOBER 30, 1999  
SCALE: 1" = 200'  
PROJECT NUMBER: 99-04-053  
DRAWING NAME: 99-04-053REV  
SECTION 3&4, TOWNSHIP 23 SOUTH, RANGE 35 EAST

PARTY CHIEF: D. RICHTER  
DRAWN BY: M. CORNELL  
CHECK BY: S.G. JACKSON  
SHEET: 1 OF 1

BREVARD COUNTY  
TRANSPORTATION  
ENGINEERING  
SURVEYING & MAPPING  
2725 JUDGE FRAN JAMIESON WAY  
BUILDING A, SUITE A220  
VIERA, FL. 32940  
PHONE (321)633-2080

